



BE THE ONE



PENTHOUSE  
I & II



**WHERE HEIGHT  
HOLDS MEANING**

At the edge of the sky stands an offering of rare air.  
A landmark of global recognition – accessible yet  
reserved for those who rise beyond.



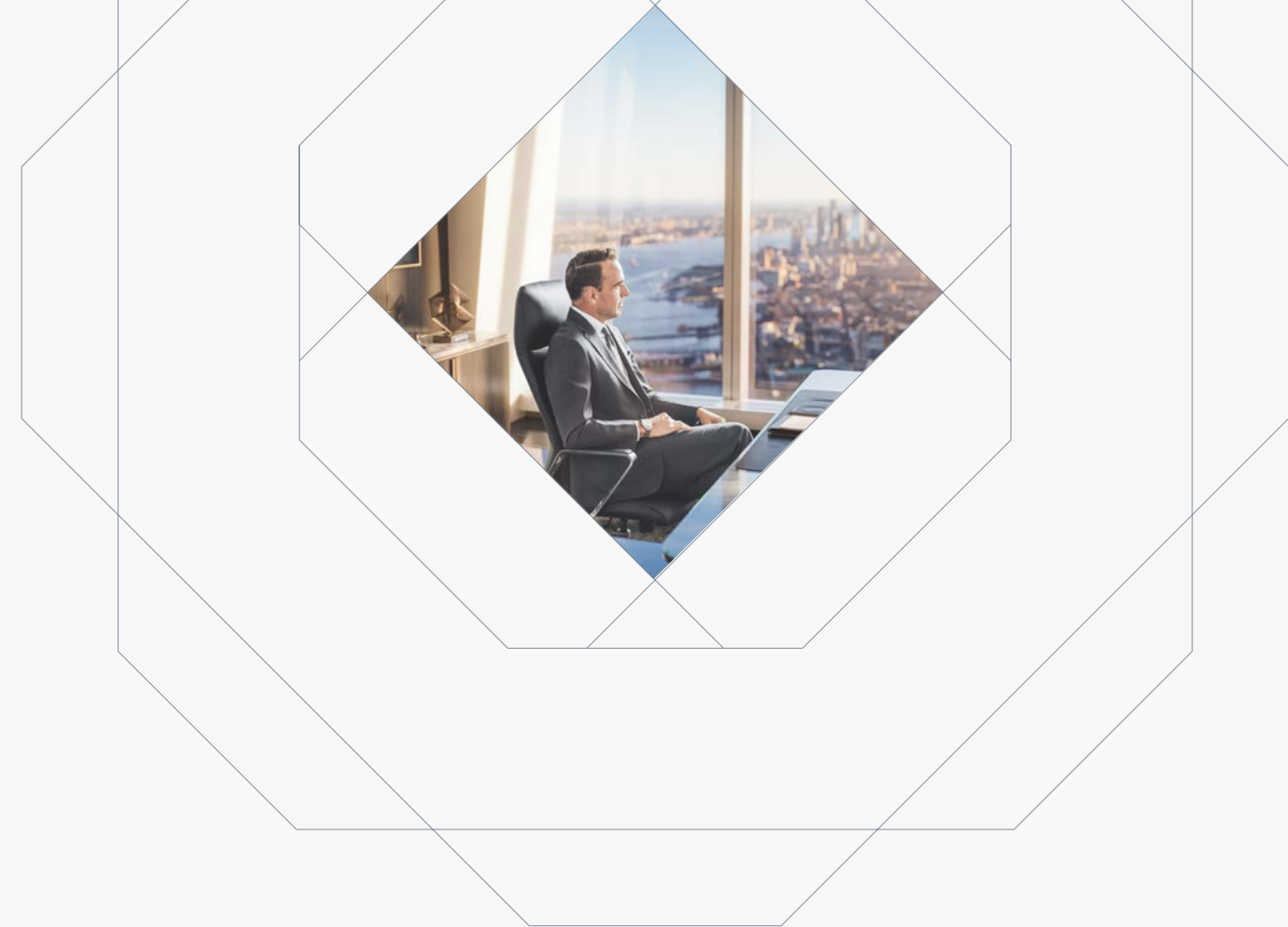

## AIR, UNTOUCHED

Rise to the highest office floors in the nation. Here, altitude becomes opportunity – light-filled and limitless.

## SPACE, AMPLIFIED

Ceilings soar to 23 feet. Double-height windows give way to the world. A luminous experience – expanded in every direction.





**PERSPECTIVE  
WITHOUT PARALLEL**

360-degree views surround – Midtown to  
the Harbor, the Hudson to the East River.  
A vantage drawn in glass.





## CLARITY AFTER DARK

Ambition doesn't dim at dusk, it deepens – quietly, clearly, with intent.





# CORE & SHELL

MIDTOWN MANHATTAN



NEW YORK HARBOR



PENTHOUSE I  
33,043 SQ FT



# TEST FIT

MIDTOWN MANHATTAN

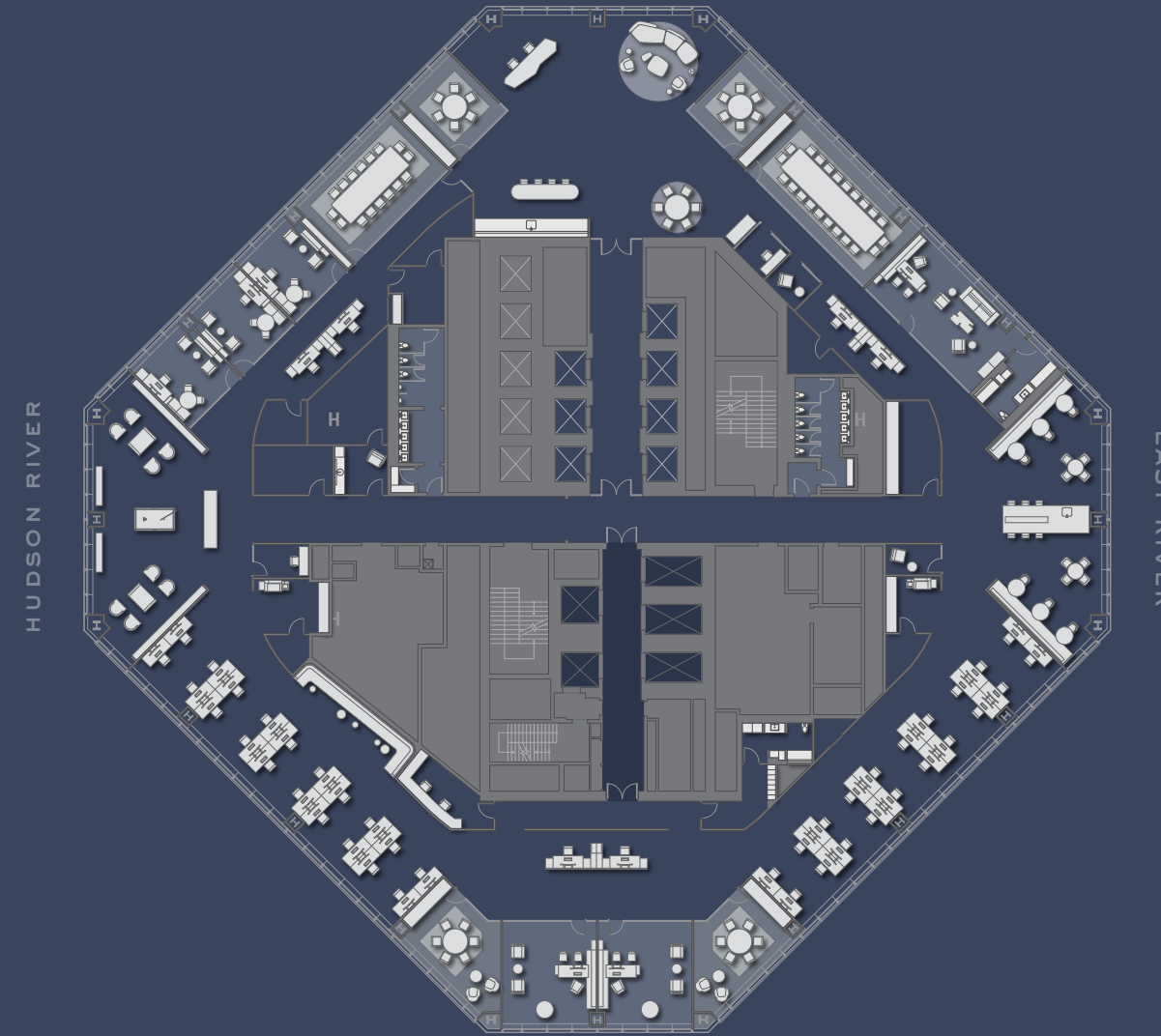

NEW YORK HARBOR

Reception	2
Executive Office	3
Office	3
Administrative Assistant	6
Workstation	40
<b>TOTAL HEADCOUNT</b>	<b>54</b>
CONFERRING	62

# CORE & SHELL

MIDTOWN MANHATTAN

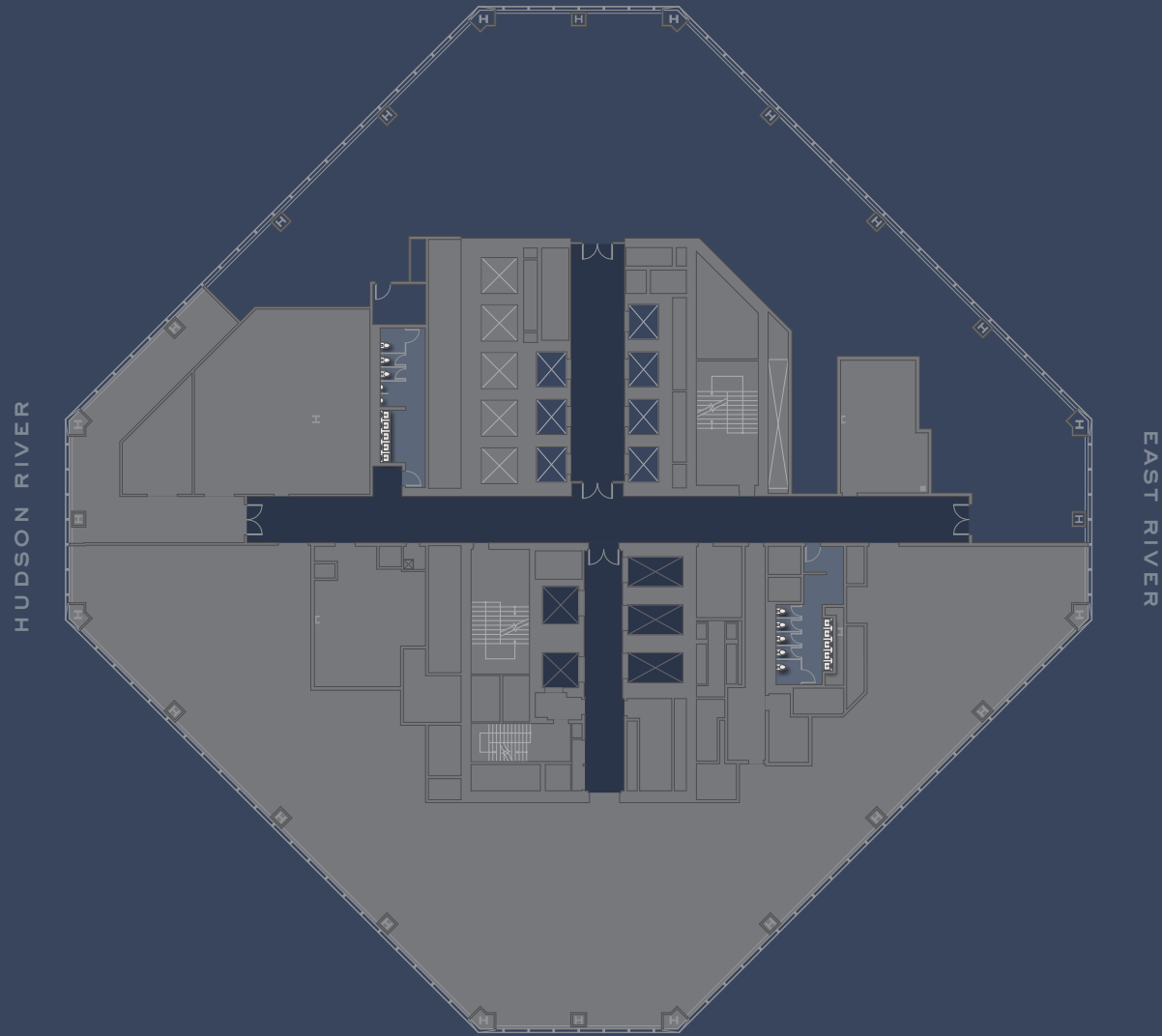

NEW YORK HARBOR

**ONE**  
WORLD TRADE CENTER

PENTHOUSE II  
**12,908 SQ FT**

# TEST FIT

MIDTOWN MANHATTAN

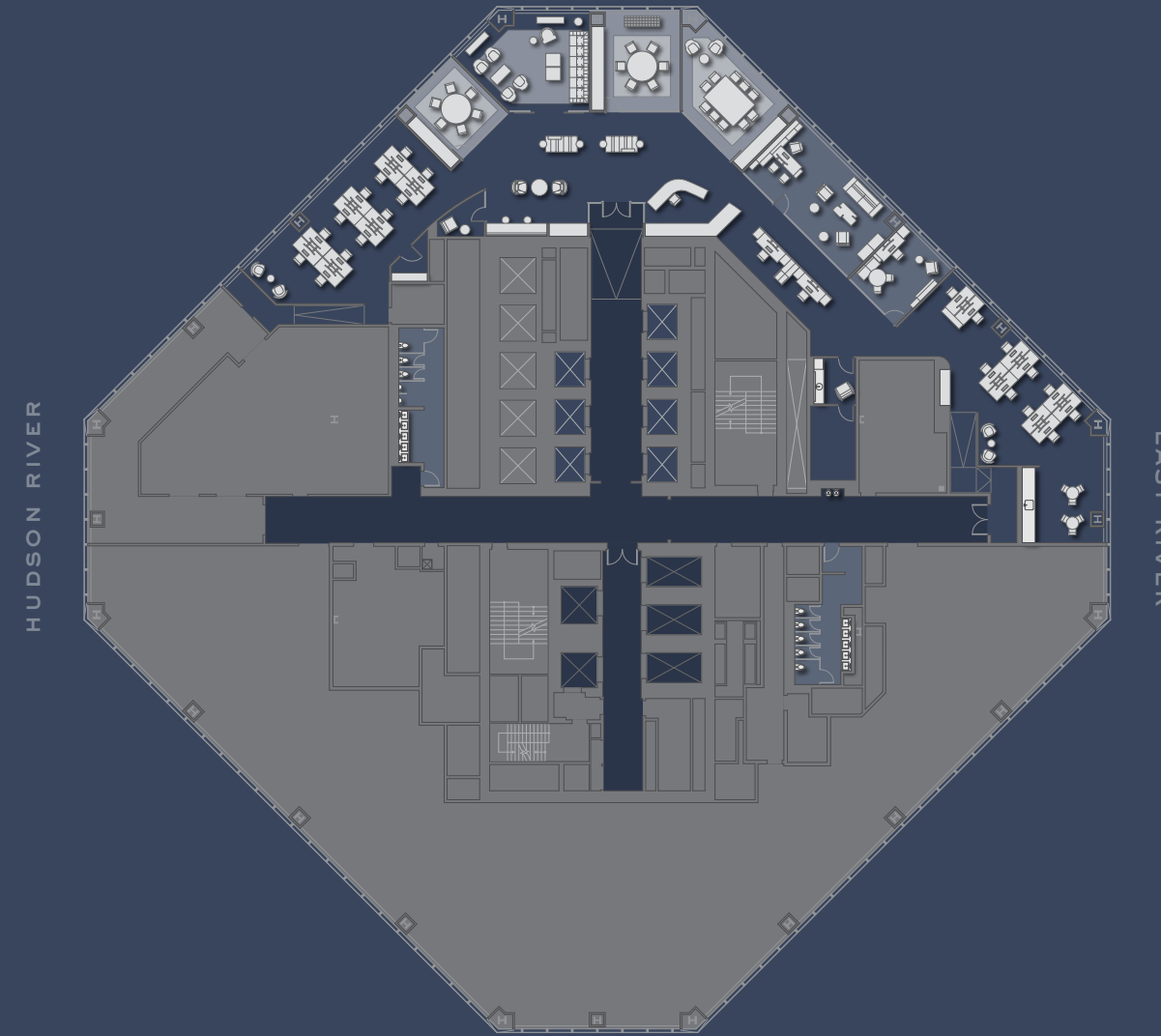

NEW YORK HARBOR

Reception	1
Executive Office	1
Office	1
Administrative Assistant	2
Workstation	22
<b>TOTAL HEADCOUNT</b>	<b>27</b>
CONFERRING	22

TEST FIT

MIDTOWN MANHATTAN

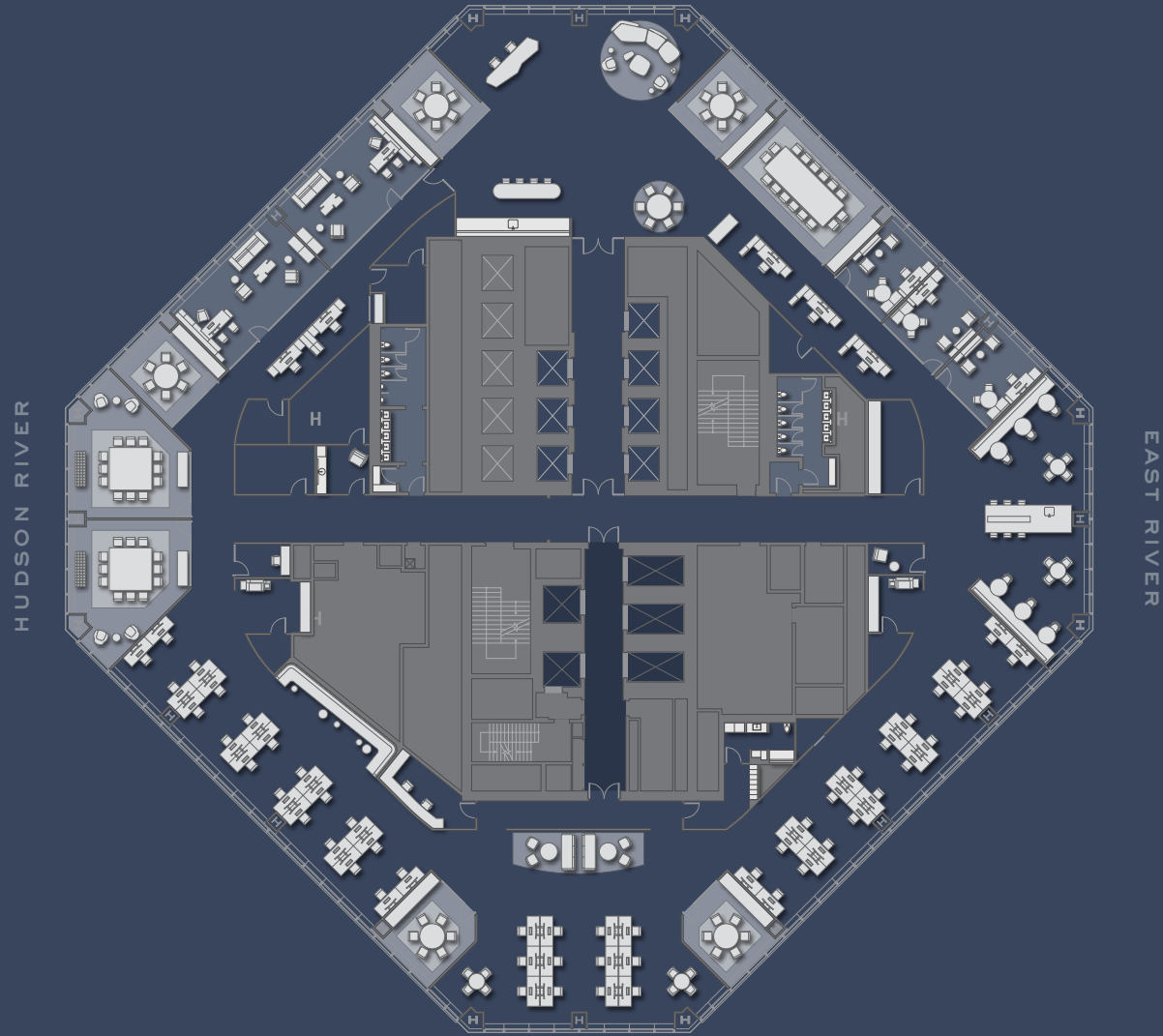

HUDSON RIVER

EAST RIVER

NEW YORK HARBOR



PENTHOUSE I & II  
 46,951 SQ FT



TEST FIT

MIDTOWN MANHATTAN

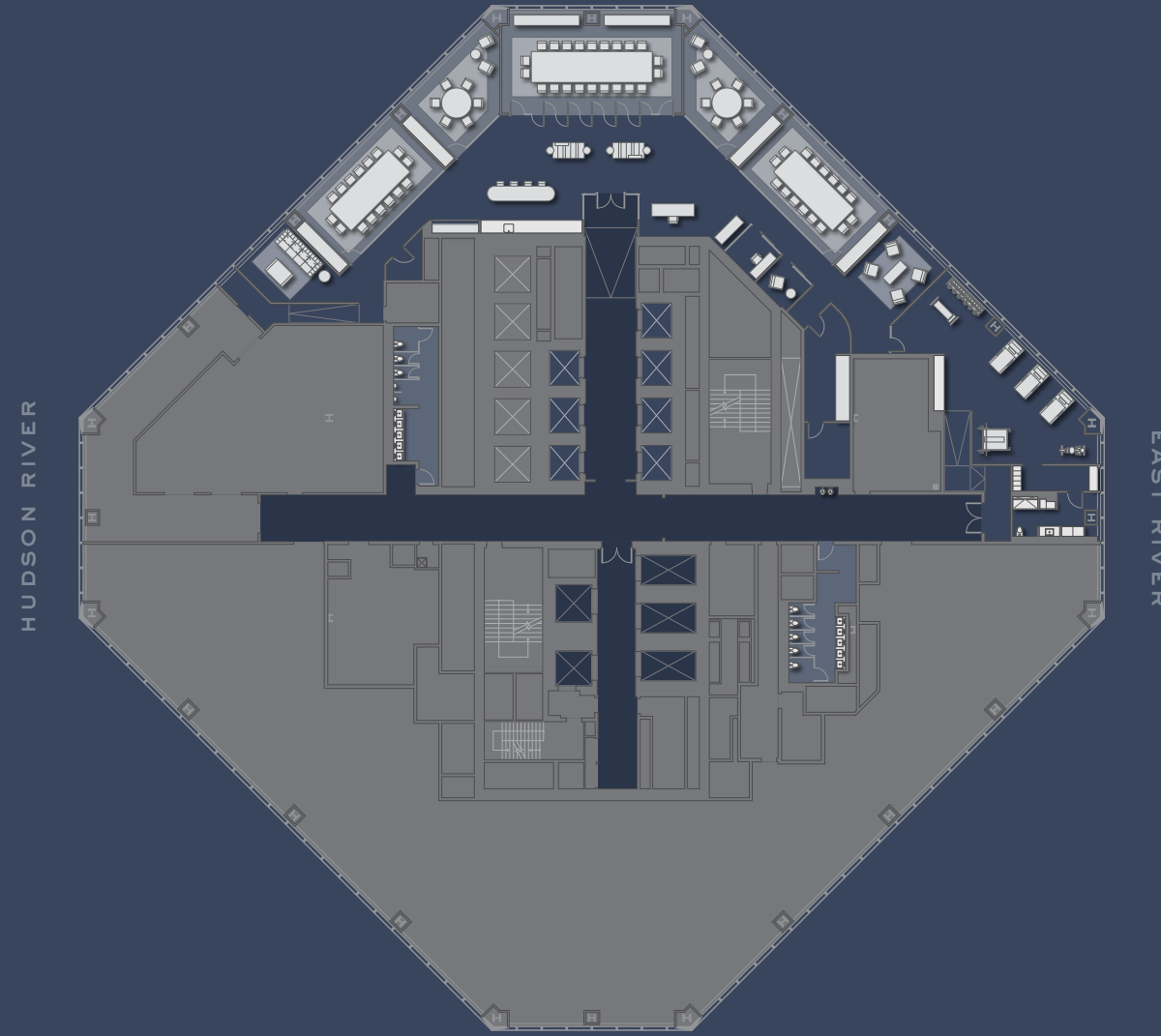

HUDSON RIVER

EAST RIVER

NEW YORK HARBOR

Reception	3
Executive Office	2
Office	3
Administrative Assistant	5
Workstation	52
<b>TOTAL HEADCOUNT</b>	<b>65</b>
CONFERENCING	130

## LEASING INQUIRIES

---



**ERIC ENGELHARDT**

212.667.8704  
eengelhardt@durst.org

**KAREN ROSE**

212.667.8705  
krose@durst.org

**SAYO KAMARA**

212.667.8710  
skamara@durst.org

## NEWMARK

**DAVID FALK**

212.372.2271  
david.falk@nmrk.com

**HAL STEIN**

212.233.8185  
hal.stein@nmrk.com

**PETER SHIMKIN**

212.372.2150  
peter.shimkin@nmrk.com

**NATHAN KROPP**

212.372.2056  
nathan.kropp@nmrk.com

**PAIGE RAISIDES**

212.655.1227  
paige.raisides@nmrk.com



**ONE**<sup>TM</sup>  
WORLD TRADE CENTER

PENTHOUSE  
I & II