

**ONE**<sup>™</sup>  
WORLD TRADE CENTER

**BE THE ONE**  
PENTHOUSE I & II





**ONE**<sup>™</sup>  
WORLD TRADE CENTER

**PENTHOUSE  
I & II**

## WHERE HEIGHT HOLDS MEANING

*At the edge of the sky stands an offering of rare air.  
A landmark of global recognition – accessible yet  
reserved for those who rise beyond.*





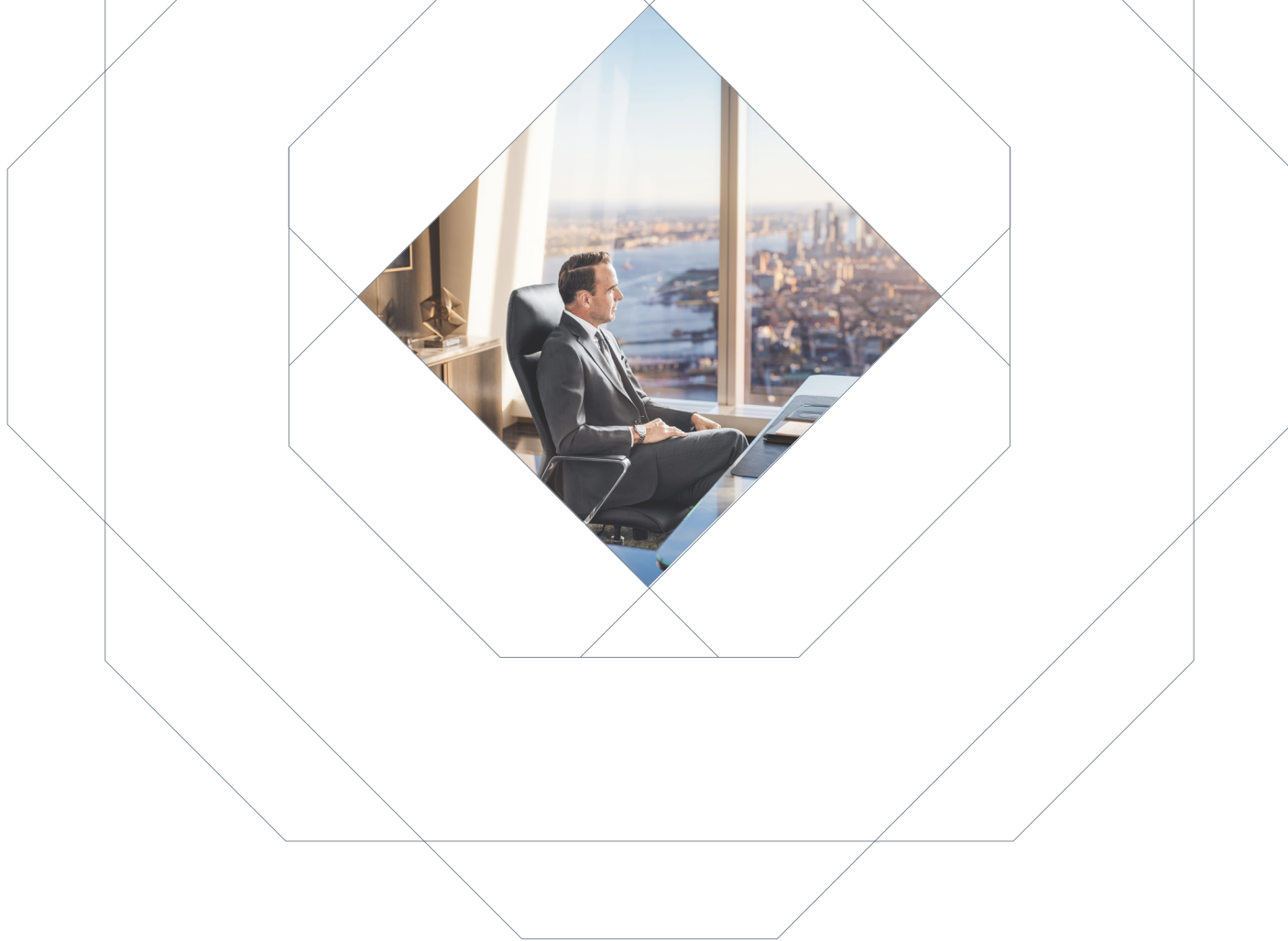

## AIR, UNTOUCHED

Rise to the highest office floors in the nation. Here, altitude becomes opportunity – light-filled and limitless.

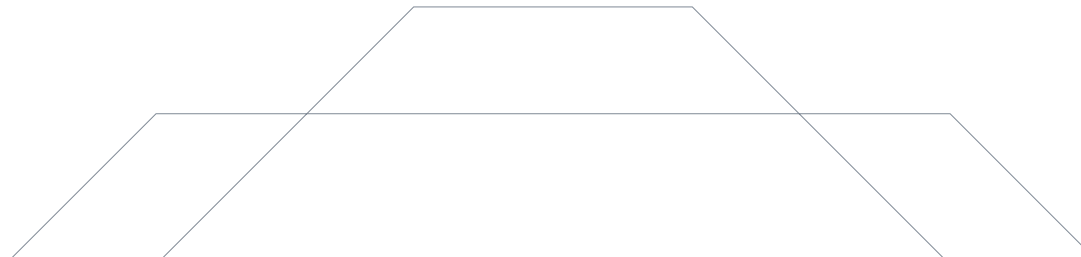





## SPACE, AMPLIFIED

Ceilings soar to 23 feet. Double-height windows give way to the world. A luminous experience – expanded in every direction.





## PERSPECTIVE WITHOUT PARALLEL

360-degree views surround – Midtown to  
the Harbor, the Hudson to the East River.  
A vantage drawn in glass.



# CLARITY AFTER DARK

Ambition doesn't dim at dusk, it deepens – quietly, clearly, with intent.







# CORE & SHELL

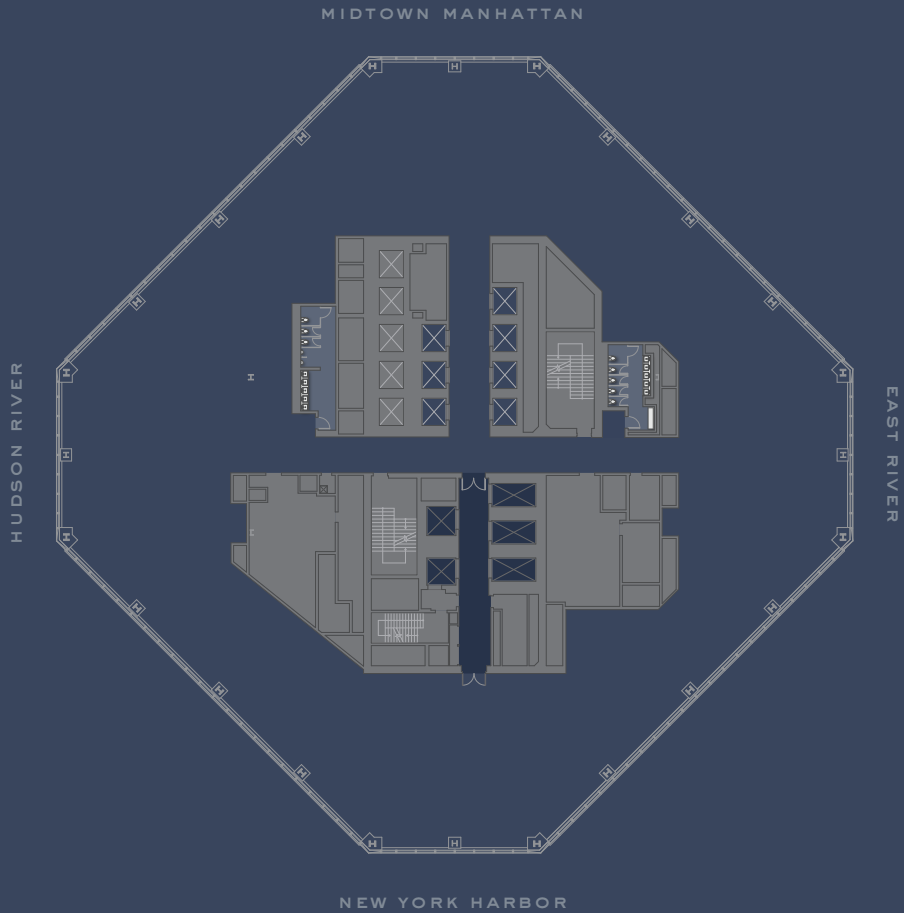

# TEST FIT

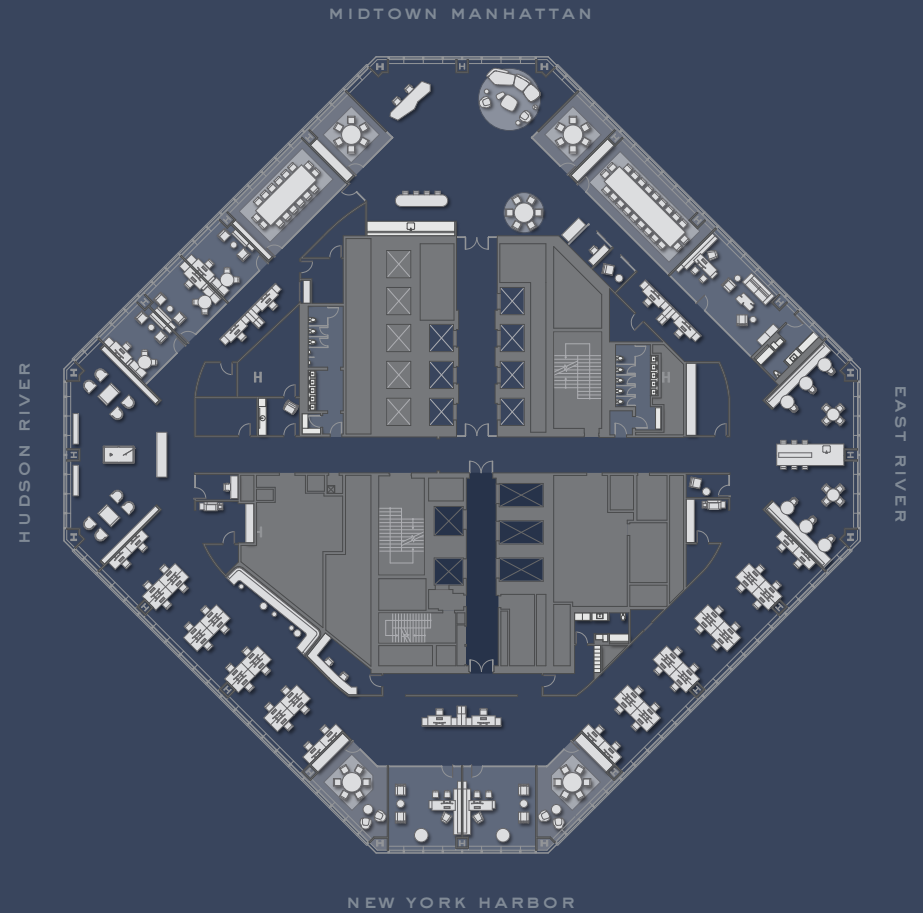

PENTHOUSE I  
**33,043 SQ FT**



**ONE**<sup>TM</sup>  
 WORLD TRADE CENTER

Reception	2
Executive Office	3
Office	3
Administrative Assistant	6
Workstation	40
<b>TOTAL HEADCOUNT</b>	<b>54</b>
<b>CONFERENCING</b>	<b>62</b>

# CORE & SHELL

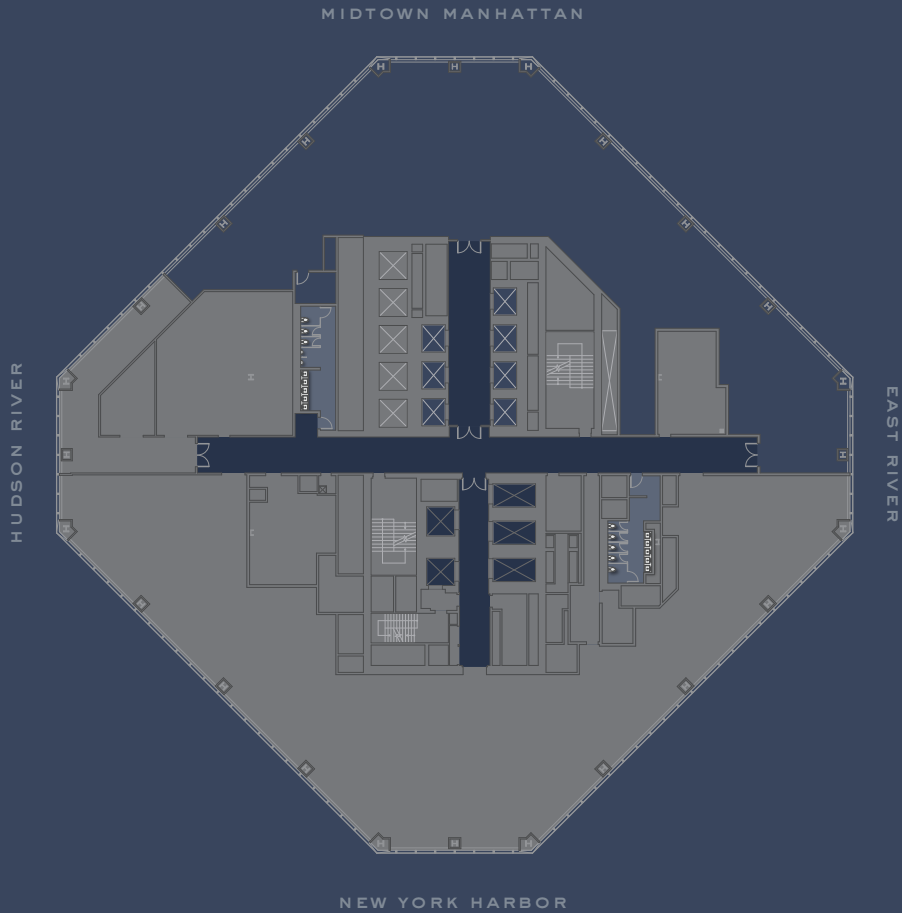

# TEST FIT

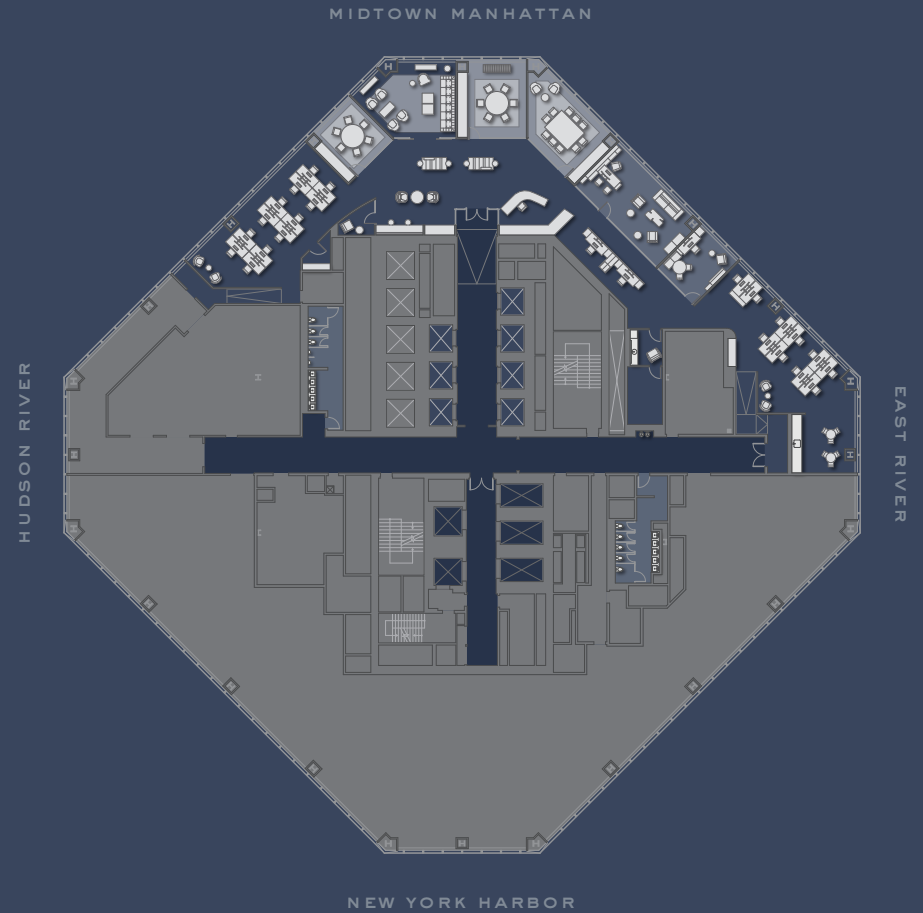

PENTHOUSE II  
**12,908 SQ FT**



**ONE**<sup>TM</sup>  
 WORLD TRADE CENTER

Reception	1
Executive Office	1
Office	1
Administrative Assistant	2
Workstation	22
<b>TOTAL HEADCOUNT</b>	<b>27</b>
<b>CONFERENCING</b>	<b>22</b>

# CORE & SHELL

# TEST FIT

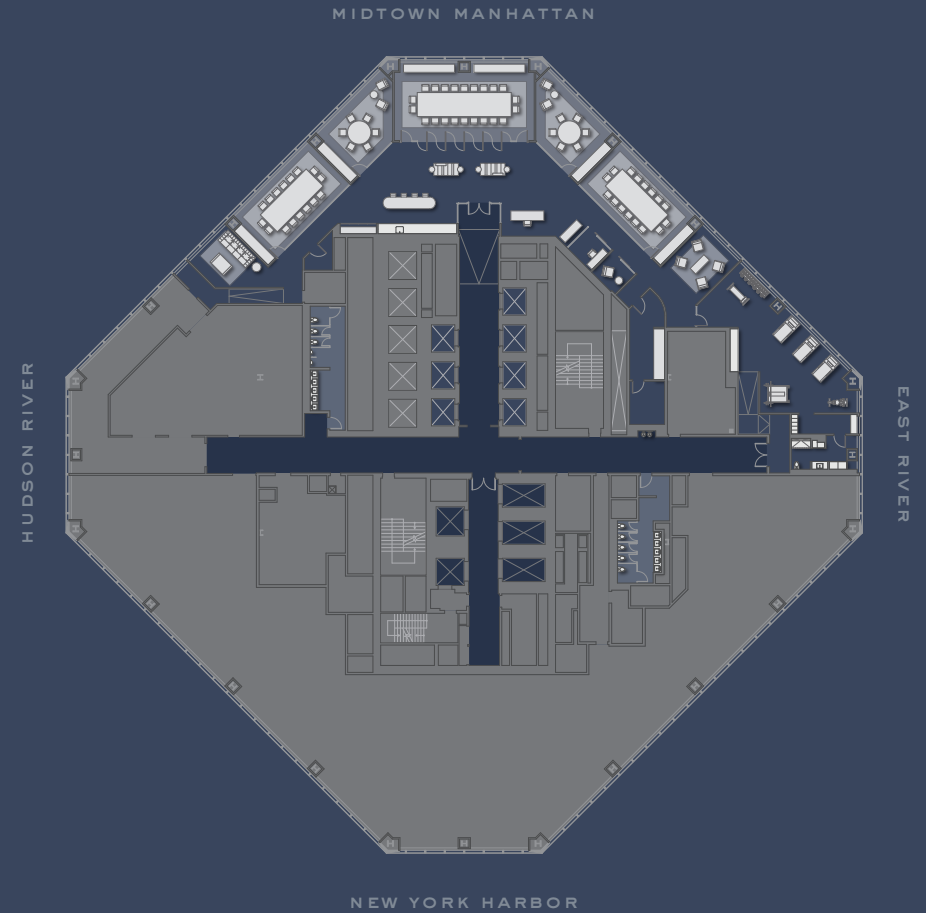
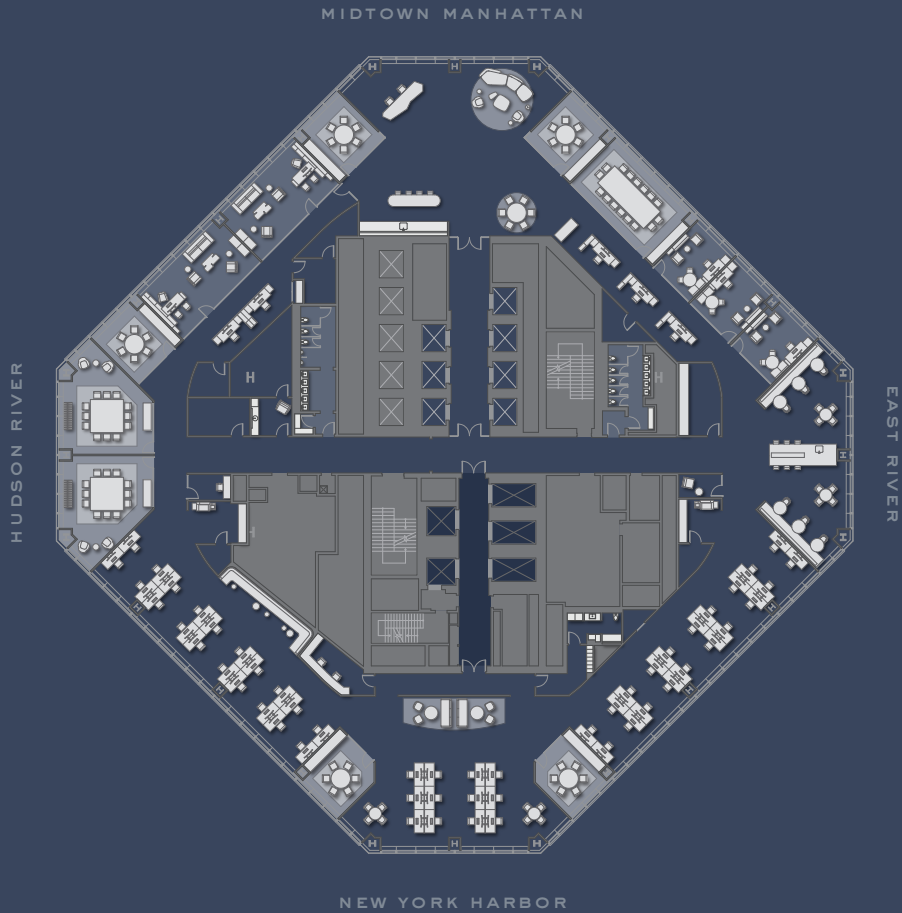

PENTHOUSE I & II  
**49,951 SQ FT**



**ONE**<sup>TM</sup>  
 WORLD TRADE CENTER

Reception	3
Executive Office	2
Office	3
Administrative Assistant	5
Workstation	52
<b>TOTAL HEADCOUNT</b>	<b>65</b>
<b>CONFERENCING</b>	<b>130</b>



PENTHOUSE  
I & II

## LEASING INQUIRIES



ERIC ENGELHARDT

KAREN ROSE

SAYO KAMARA

DAVID FALK

HAL STEIN

PETER SHIMKIN

NATHAN KROPP

PAIGE RAISIDES

212.667.8704  
eengelhardt@durst.org

212.667.8705  
krose@durst.org

212.667.8710  
skamara@durst.org

212.372.2271  
david.falk@nmrk.com

212.233.8185  
hal.stein@nmrk.com

212.372.2150  
peter.shimkin@nmrk.com

212.372.2056  
nathan.kropp@nmrk.com

212.655.1227  
paige.raisides@nmrk.com

